

Quick VM creation on the local cloud

Access VM creation form

In the VMs tab, click on the "plus" button to display the VM creation form :

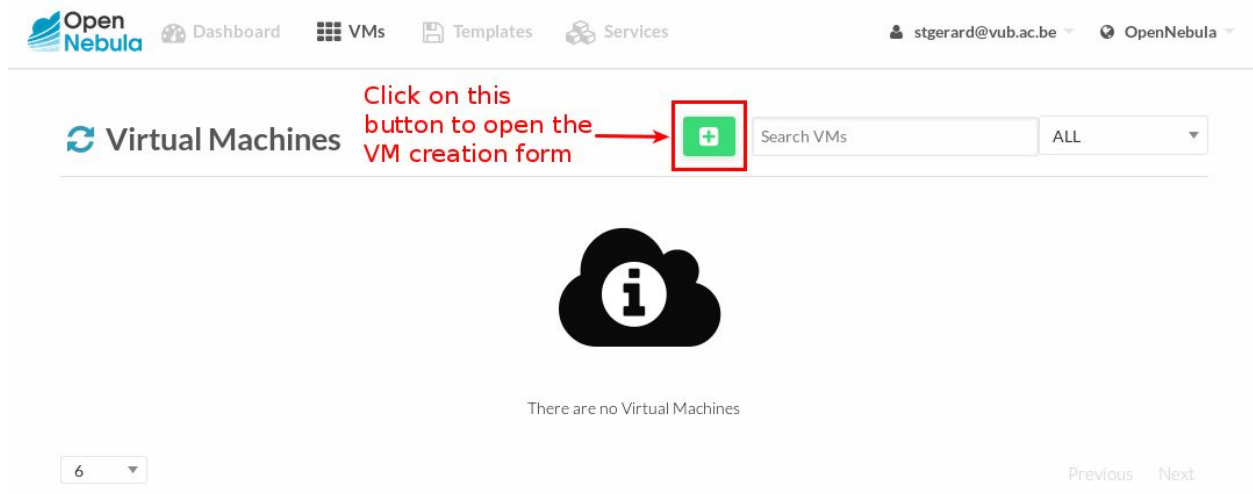

Select a VM template

Select the template that best suits your needs :

Create Virtual Machine



Persistent ?

[Create](#)

Template

ALL

Labels

SL68 basic



Scientific Linux 6.8 basic
Virtual Machine. Login as
"scilinux".

group

GenePattern_3.9.9



GenePattern 3.9.9 on
Scientific Linux 6.8. Log in
with "scilinux" account (it's
a sudoers). R 2.5.0 was
installed under /usr/local
(in /usr/local/lib64/R).

group

SL73 basic



Scientific Linux 7.3 basic
Virtual Machine, with the
main development tools
installed. Please ssh-login
to the VM as "scilinux"
user.

group

Jupyter_EL7



Jupyter on Scientific Linux
7.3. Login to the machine
like this : ssh -L
8888:localhost:8888
scilinux@<VM_IP> Then
launch Jupyter notebook :
jupyter notebook And
copy-paste the displayed
URL in your browser and
enjoy !

group

Select the
template that
suits best to your
needs.

Launch the VM creation

Before launching the VM creation, you can adjust some its hardware characteristics :

Open Nebula Dashboard VMs Templates Services stgerard@vub.ac.be OpenNebula

Create Virtual Machine

Virtual Machine Name ☐ Persistent ?

Template

SL68 basic

Capacity

Memory 4 GB

CPU 4 VCPU 4

Disks

DISK 0: SL68_basic_vm_context-disk-0 40000

1. Optionally, you can specify a custom machine name.

2. Optionally, you can adapt the hardware characteristics of the VM.

3. Once you are confident with your choices, you can start the instantiation process by clicking on this button.

Waiting for the VM to be in "running" status

It might take a few minutes before the VM is ready :

Open Nebula Dashboard VMs Templates Services stgerard@vub.ac.be OpenNebula

Virtual Machines Search VMs ALL

SL68 basic-284

x4 - 4GB - SL68_basic_vm_context-disk-0

193.58.172.166

stgerard@vub.ac.be -33s ago

Button to actualize the status of the VM

The color of this small square indicates the status of the VM. When green, the VM is in the "running" status, i.e. it is ready to be accessed.

6 Previous 1 Next

When the VM is ready, you can take note of its IP and click on its name to get the management screen :

Virtual Machines



Search VMs

ALL

SL68 basic-284

x4 - 4GB - SL68_basic_vm_context-disk-0

193.58.172.166

stgerard@vub.ac.be

5m ago



The VM is ready !

The IP address of the VM, that you will need when you will have to connect with SSH.

6

Previous

1

Next

Monitoring and managing your VM

The management screen displays some statistics and offers the possibility to restart/shutdown/delete the VM :

SL68 basic-284



RUNNING

x4 - 4GB - SL68_basic_vm_context-disk-0

193.58.172.166

stgerard@vub.ac.be 5m ago - ID: 284



CPU



Net TX



Memory



Net Download Speed



Net RX



Net Upload Speed

